



Fidus-Battery Monitoring App SOP (PylontechPro)

Information Version: 1.0

Legal Information

Copyright©2026 Pylon Technologies Co., Ltd. All rights reserved.

Any reproduction or distribution of this manual or any part of this manual, or any uploading of this manual to a third party website, in any form by any means, without the prior written consent of Pylon Technologies Co., Ltd., is prohibited.

Disclaimer

The manual contains instructions for the use of the product. All the pictures and charts in this manual are for description and explanation only. Pylon Technologies Co., Ltd. reserves the right to change the information in the manual which is subject to change without further notice.

Please read this manual carefully before using the product and keep this manual for further reference. Failure to use the product in accordance with the manual may result in serious injuries, property damages and may void the warranty, for which Pylon Technologies Co., Ltd. shall not be liable.

Pylon Technologies Co., Ltd. makes no representations or warranties express or implied, with respect to all the information in this manual.

In the event of any conflicts between this manual and the applicable law, the latter prevails.

The final interpretation of this manual belongs to Pylon Technologies Co., Ltd.

About this Manual





Purpose

This manual introduces the download and installation, login procedures, configuration settings, and power station management of the PylontechPro app.

Applicable Model

- FB-L-5.12/ FB-L-5.12-PK
- FB-L-5.12-EU/ FB-L-5.12-EU-Pro
- FB-L-16/ FB-L-16-PK

Explanation of Symbols

Symbol	Description
 DANGER	Indicates a hazard with a high level of risk which, if not avoided, will result in death or serious injury.
 WARNING	Indicates a hazard with a medium level of risk which, if not avoided, could result in death or serious injury.
 CAUTION	Indicates a hazard with a low level of risk which, if not avoided, could result in minor or moderate injury.
 NOTE	Indicates additional information, emphasized contents, or important points helping you use the product better.

Contents

Legal Information	I
About this Manual.....	II
Purpose	II
Applicable Model	II
Explanation of Symbols.....	II
Contents.....	III
1 Download and Install the PylontechPro App	1
2 Login	2
2.1 Account sign-up.....	2
2.1.1 Sign-up as a User for installers and operation staffs.....	2
2.1.2 Sign-up as an Organization for organization administrators:	4
2.2 Login	5
3 Local Config.....	6
3.1 Local Configuration via Bluetooth.....	6
3.2 Upgrade Notification	7
3.3 WIFI Config and Create Plant.....	8
3.3.1 Step 1: WIFI Config	8
3.3.2 Step 2: Setup for the plant.....	9
3.3.3 Step 3: Installation image upload	10
4 Plant Management	11
4.1 Plant Overview.....	11

1 Download and Install the PylontechPro App

For Android, search for PylontechPro in Google play.

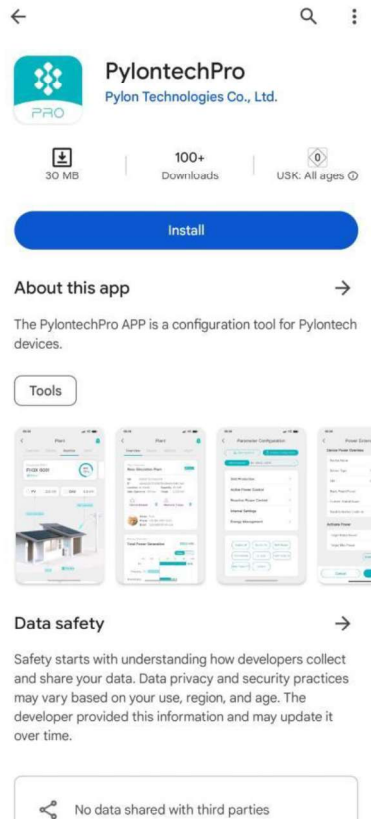

For IOS, search for PylontechPro in APP store.

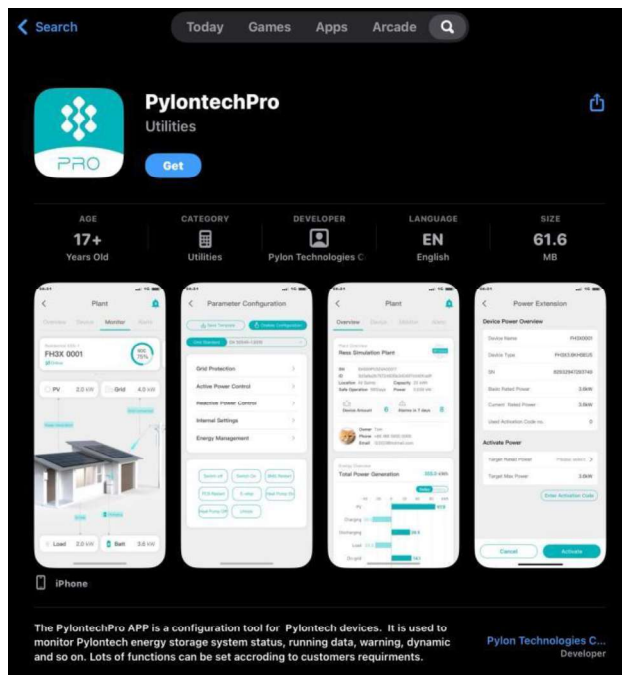

2 Login

2.1 Account sign-up

Please select server in the corresponding region.

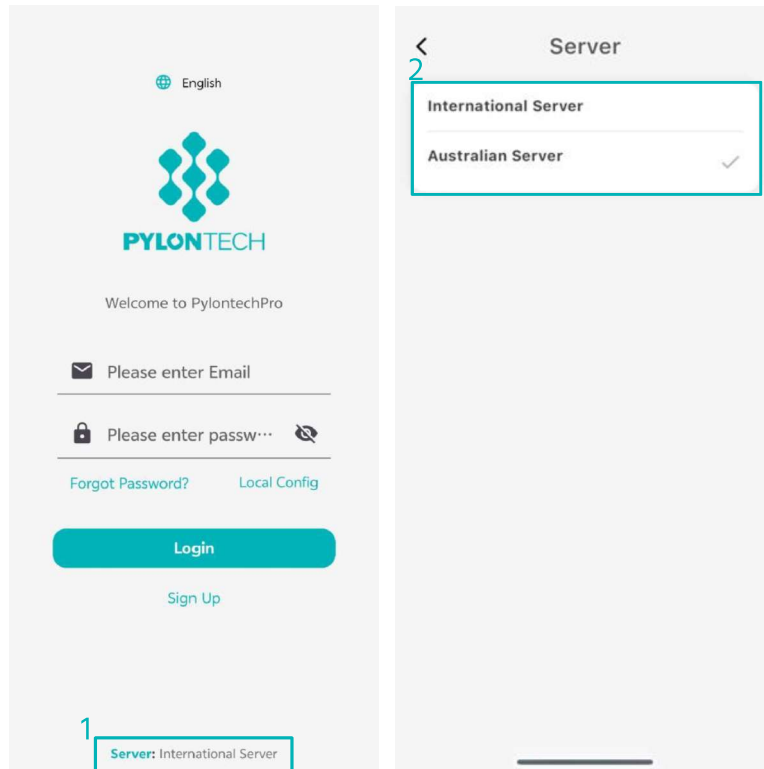

There are two roles available for registration at Pylontechpro: User and Organization.

2.1.1 Sign-up as a User for installers and operation staffs

Installers and operational staff have to sign up for a personal user account and associate it with their organization to access the app.

Sign Up > User

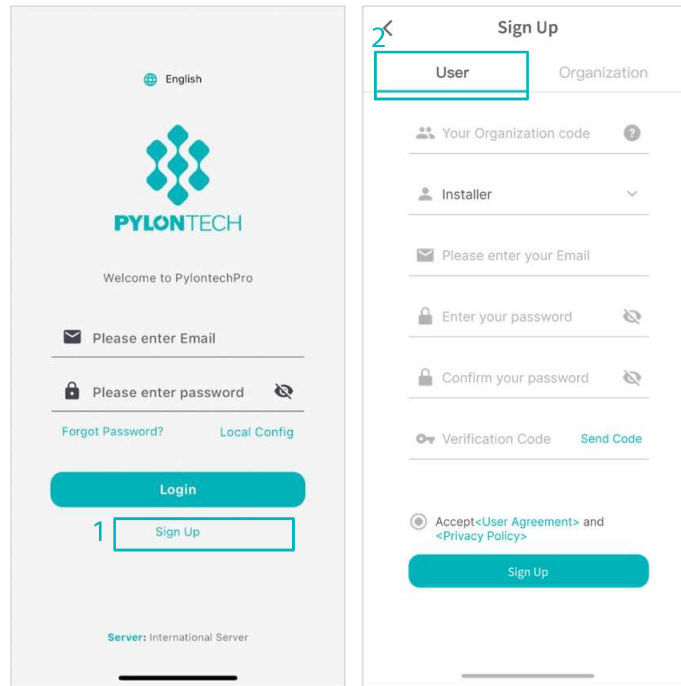

1. As an installer or operations staff member, you need to enquire your organization code from your organization administrator and enter it here.

PylontechPro is an app for professional users such as Distributors, Installers, and Operation Staff. Therefore, each user of this app must be affiliated with a registered Organization.

The organization code can be found in the web-based cloud platform via the following path:

System Management > User Management > Organization Management > Organization Information

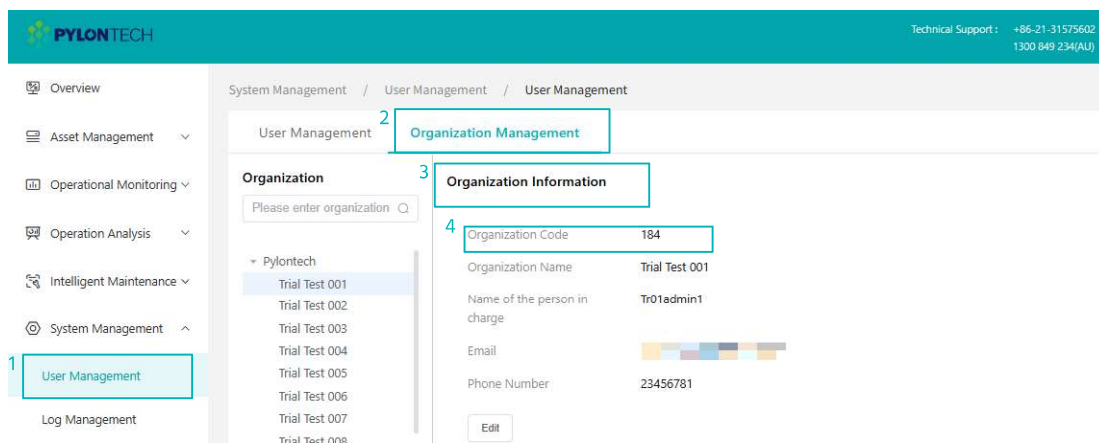

2. Choose a role: installer or Operation Staff
3. Enter your email and password, then confirm your password.

Tap "**Send Code**". A verification code will be sent to your email address.

Enter the verification code and tap "**Sign Up**". Your registration request will be sent to your Organization Administrator for authentication.

Once the administrator approves your request, your sign-up will be completed successfully.

2.1.2 Sign-up as an Organization for organization administrators:

The organization administrator needs to register the organization on the platform to manage its subordinate plants.

Sign Up > Organization

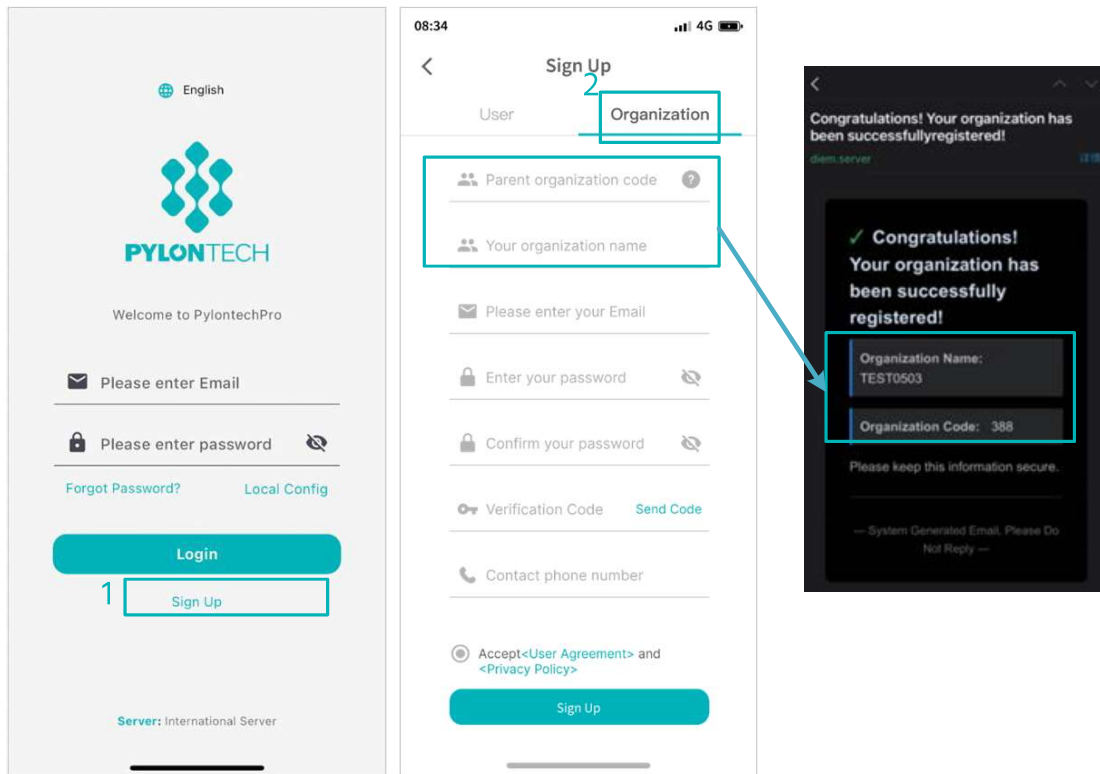

1. If your organization has an upper organization, please enter their **Organization Code** here. If parent organization code is empty, new sign up won't belong to any upper organization.

2. Enter the name of your organization.

3. Enter your email and password, then confirm your password.

Tap "**Send Code**". A verification code will be sent to your email address.

Enter the verification code and tap "**Sign Up**", and then your sign-up is finished.

4. The contact number is an optional field. However, to explore more business opportunities, it is recommended that you provide your contact information here.

5. After a short while, you will receive an email containing your organization's name and organization code. You can subsequently use this organization code to create subordinate organizations or set up installer accounts.

2.2 Login

Open the PylontechPro App, enter your email and password, click **Login** to access the system.

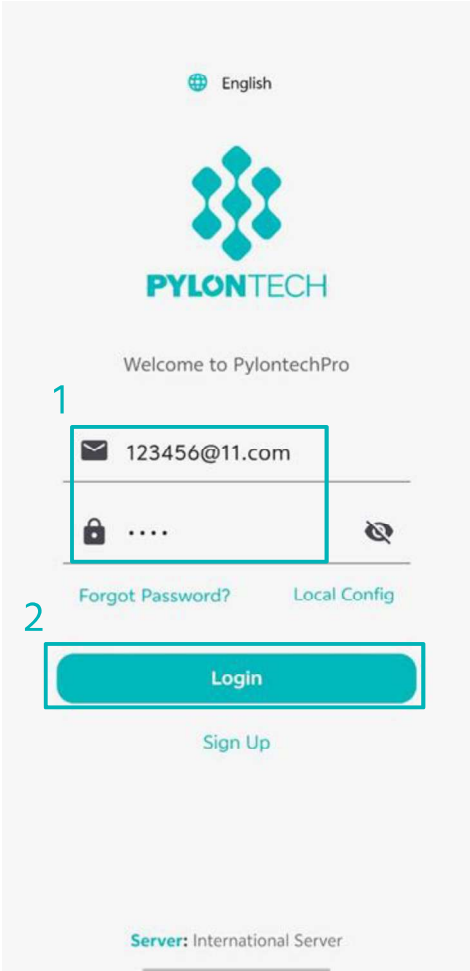

3 Local Config

3.1 Local Configuration via Bluetooth

Enable Bluetooth on the smart phone. The local config interface will display nearby Bluetooth-connected devices. Click the device to do the local configuration.



3.2 Upgrade Notification

When selecting your battery to enter Local Config, if the following dialog box appears, it indicates that the software version is outdated and requires an update. Please follow the instructions to proceed with the version update.

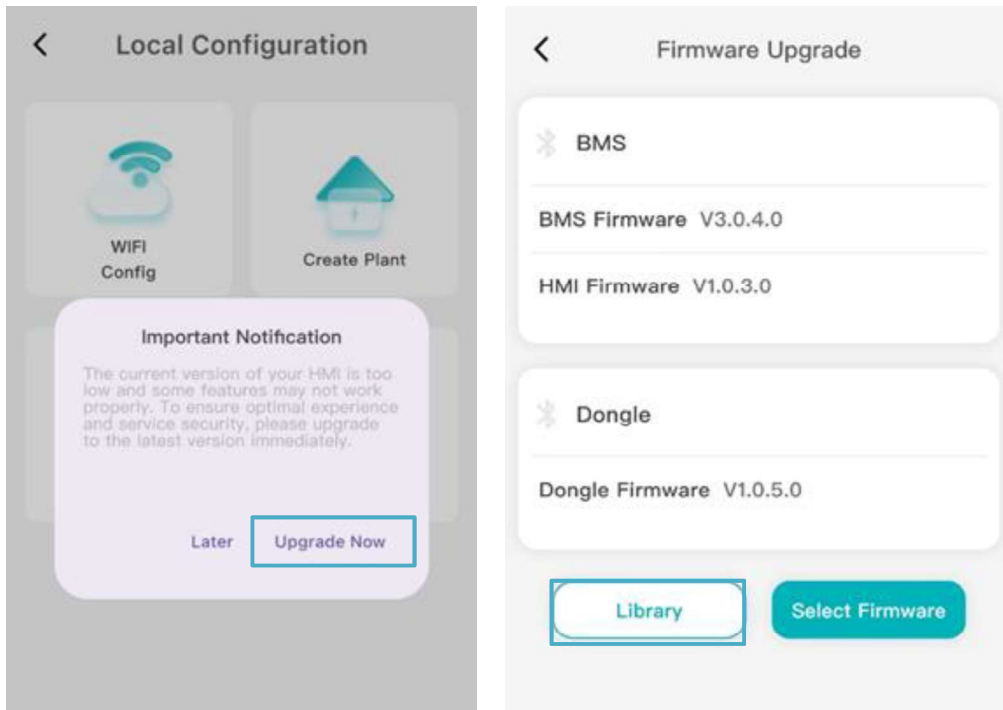

Select the latest firmware versions for the LCD, BMS, and Dongle to upgrade. Click "Download," then click "Upgrade" to proceed with the update. If all three components are outdated versions, please update them all to the latest versions.

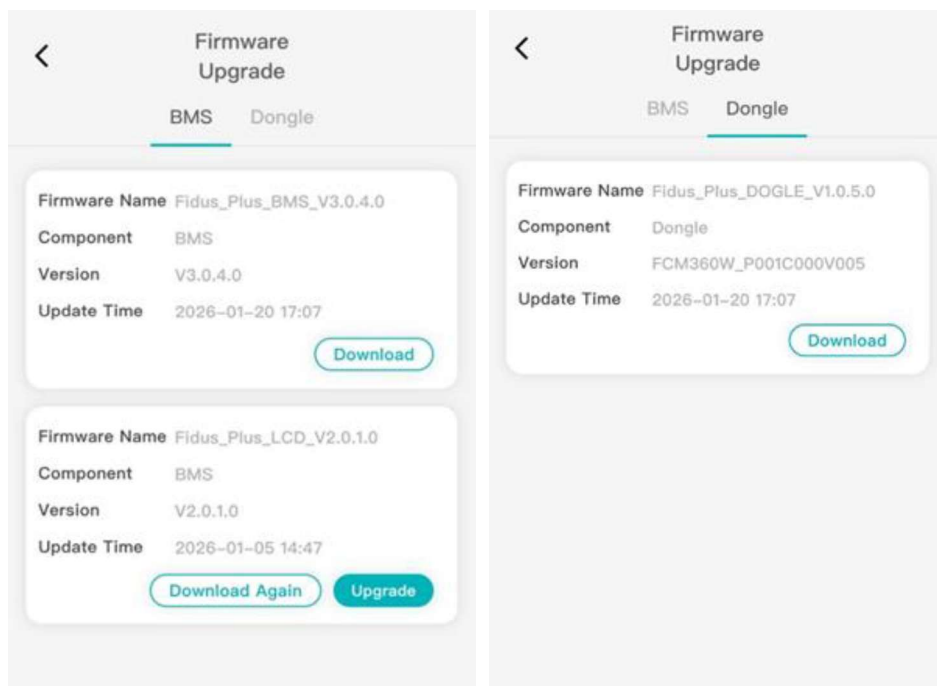

3.3 WIFI Config and Create Plant

3.3.1 Step 1: WIFI Config

Click **WIFI Config** to enter the configuration page.

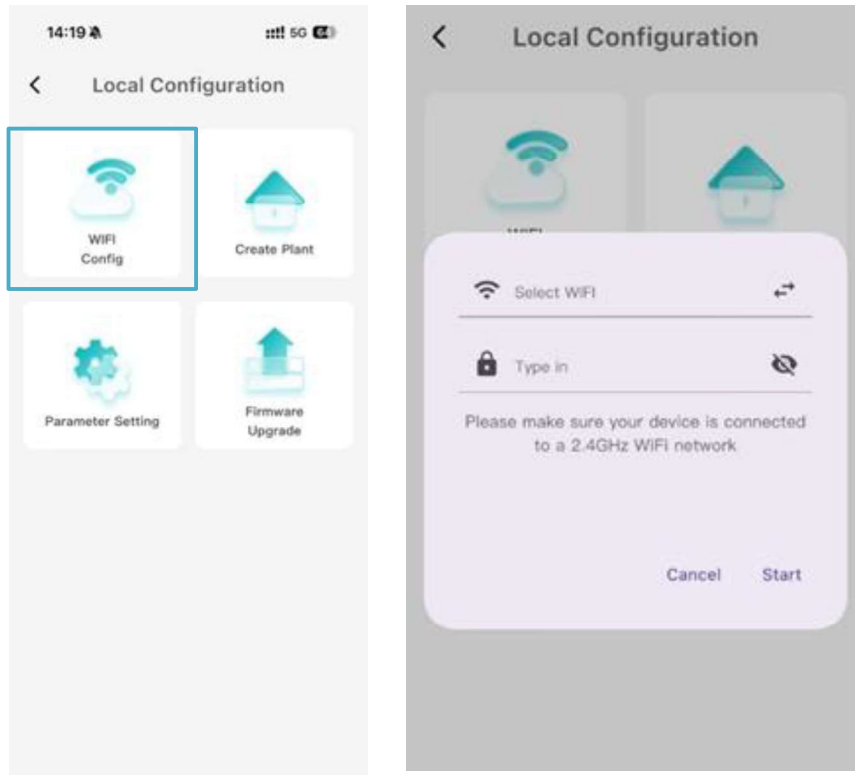

Enter the Wi-Fi account and password, then click "**Start**" and wait for the network configuration to connect.

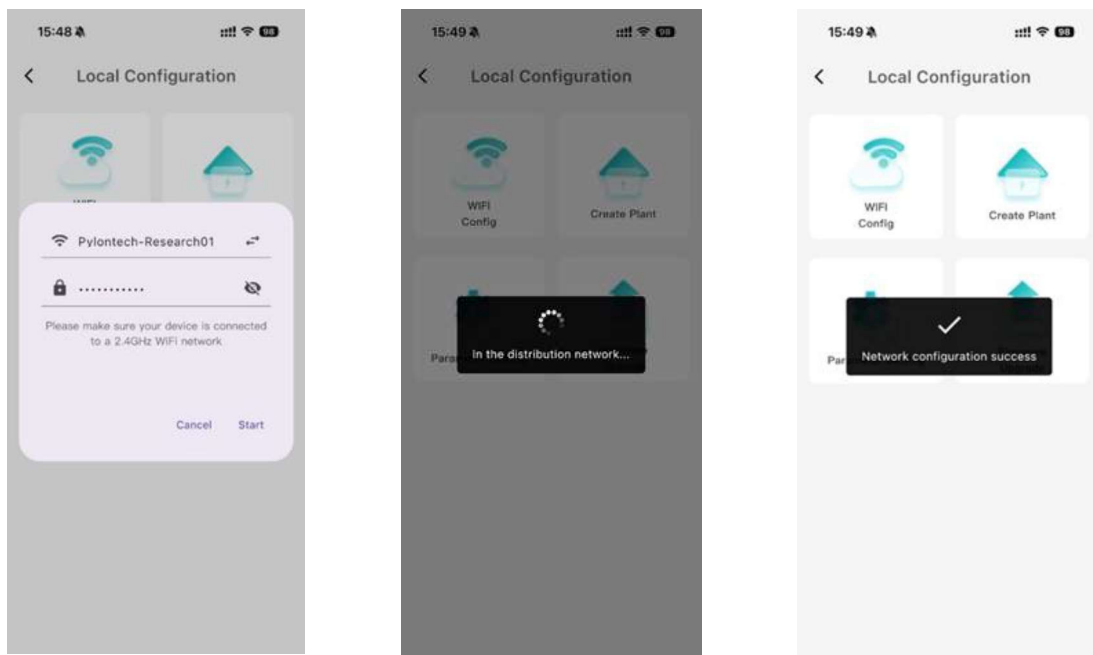

3.3.2 Step 2: Setup for the plant

Fill in the site information, and then click "Next".

New Plant Creation

1 Verify 2 **Plant** 3 Upload

* Plant Name Please enter plant name 0/40

* SN A8DD9FEB258B

* Location Please select location

* Timezone

* Owner Please enter the owner's name 0/40

* Owner Phone Please enter owner's phone 0/20

* Owner Email Please enter owner's email 0/255

Battery Capacity(kWh) 16.00

Access Time 2026-01-27

User's authorization obtained. Plant information involves personal information. Please obtain authorization in advance.

New Plant Creation

* SN A8DD9FEB258B

* Location Please select location

* Timezone

* Owner Please enter the owner's name 0/40

* Owner Phone Please enter owner's phone 0/20

* Owner Email Please enter owner's email 0/255

Battery Capacity(kWh) 16.00

Access Time 2026-01-27

User's authorization obtained. Plant information involves personal information. Please obtain authorization in advance.

Next

3.3.3 Step 3: Installation image upload

Upload an installation image of Fidus-Battery and Click "Next".

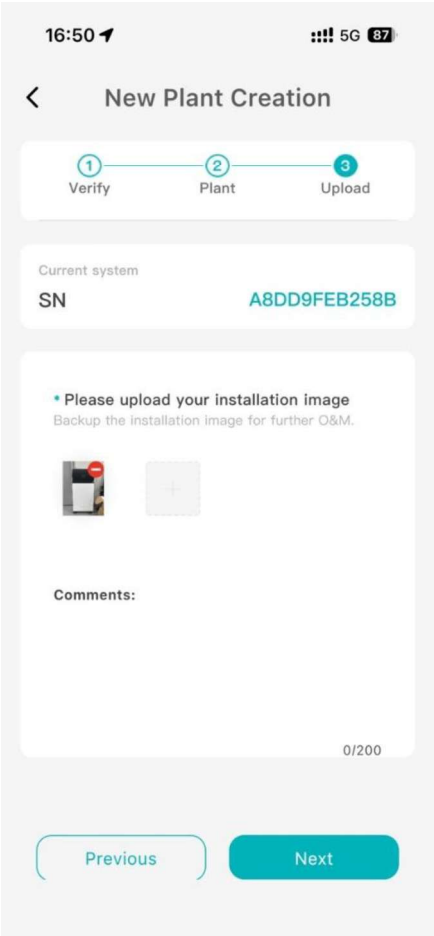

4 Plant Management

4.1 Plant Overview

Click on "Plant" and select a site to check the information.



In the **Overview**, the following items can be checked:

Plant: Energy capacity, power, and operating days can be checked

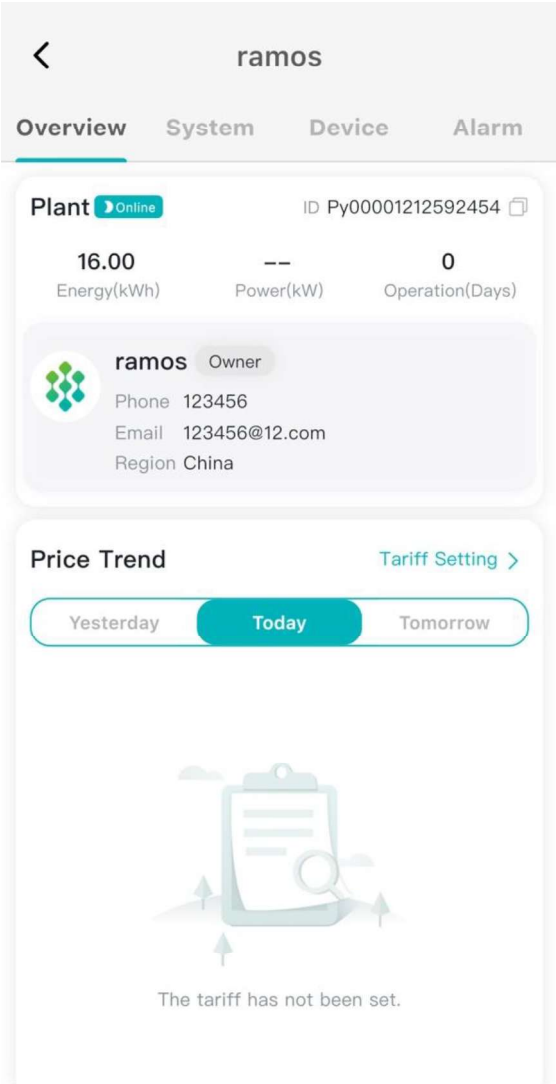

In the **System**, the following items can be checked:

System: On this page, you can view the battery SOC. Click on the battery box in the image to see more information.

Fidus Battery: On this interface, you can view the battery's system-level information. Click "Module Amount" to see detailed information about individual battery cells.

Module Details: On this interface, you can view detailed information about individual battery cells, as well as voltage and temperature data for all battery cells. To view information about other batteries in the system, click "Battery Module" and select the details you wish to see.

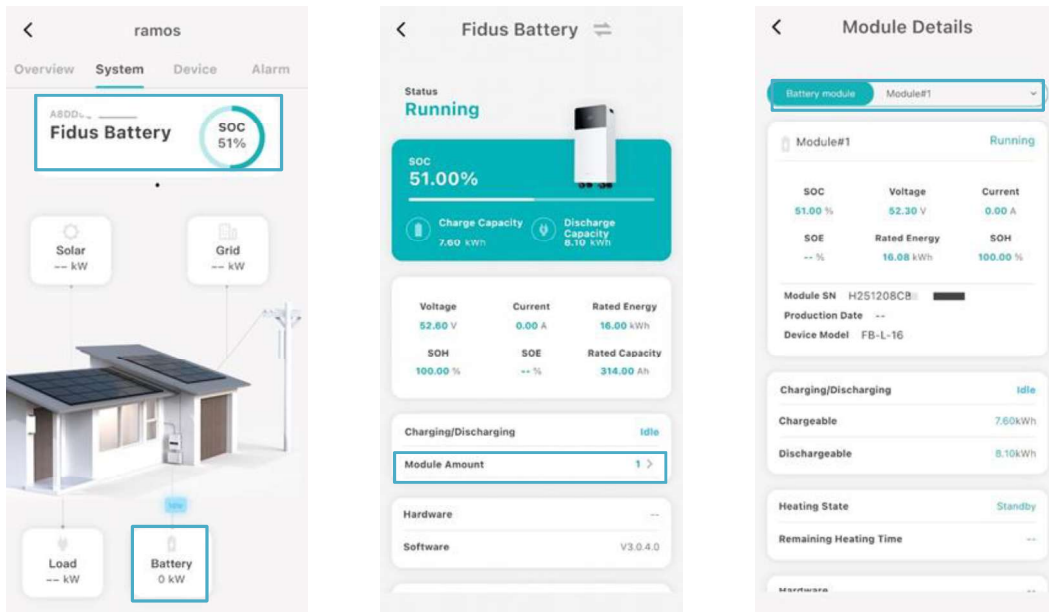

Number of devices in the plant, model, serial number, Battery capacity, power, and parallel mode for each device can be checked. On this interface, you can add or unbind devices. Multiple devices can be managed within the same site.

Click **Upgrade** to remotely upgrade the device.

Click **Settings** to configure the device, such as DOD and Baud Rate.

Click **Details** to check version information.

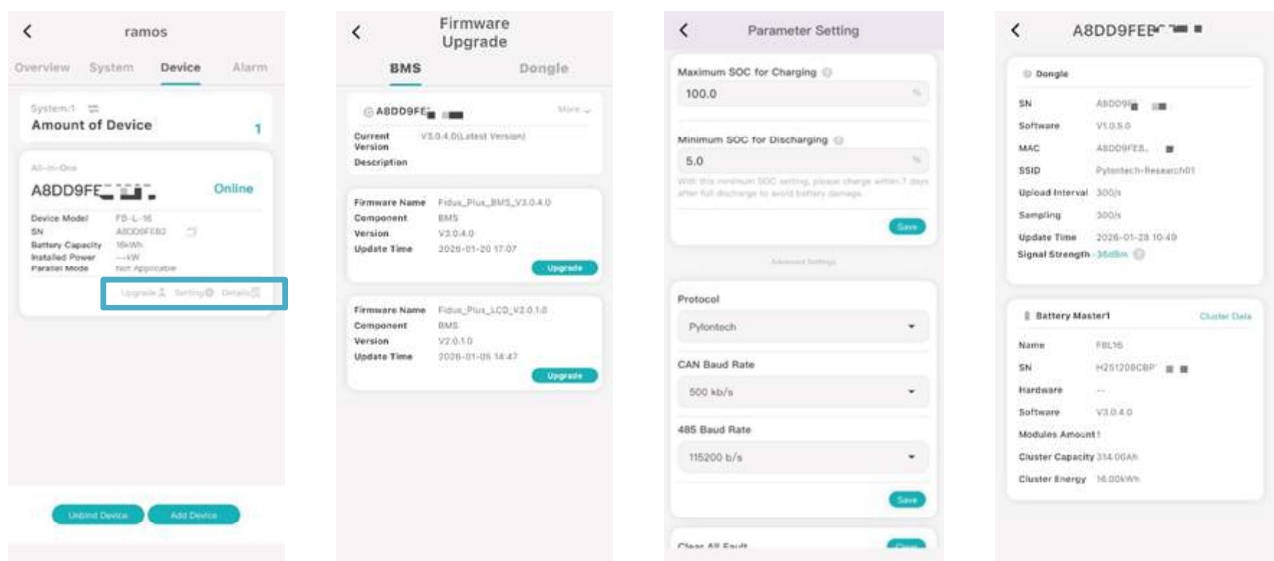

Faults and warnings can be checked in the **Alarm** section.

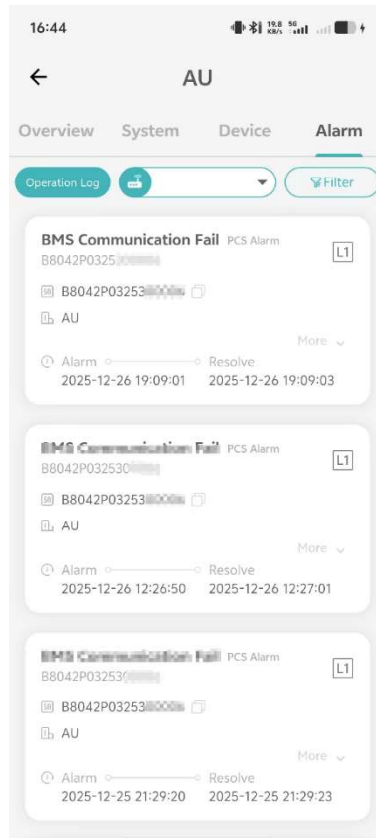



Pylon Technologies Co., Ltd.

No. 300, Miaoqiao Road, Kangqiao Town

Pudong New Area, Shanghai, 201315, China

T +86-21-51317699 | **F** +86-21-51317698

E service@pylontech.com.cn

W www.pylontech.com.cn